

Gearhead SSG15

[HOME](#)[Products](#)[Small Motors](#)[DC Coreless Motors](#)[Gearhead](#)[Gearhead SSG15](#)

Spur Gearhead

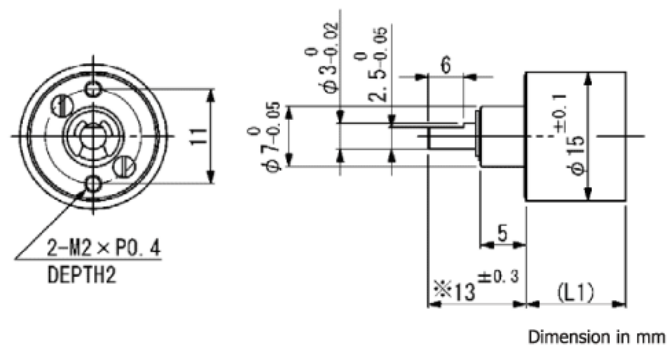

Note) Dimension marked ※ is measured with shaft pushed against gearhead.

SSG15 General specifications

		Gearhead SSG15	
1	Housing material	Metal	
2	Geartrain material	Steel	
3	Recommended max input speed	6000	rpm
4	Operation temperature range	-10...+60	°C
5	Backlash at no-load per stage	≤ 5	°
6	Bearings on output shaft	Sintered Sleeve bearings	
7	Max shaft radial load(7mm from flange)	4	N
8	Max shaft axial load	2	N
9	Max shaft press fit force	30	N
10	Shaft radial play	≤ 0.03	mm
11	Shaft axial play	≤ 0.2	mm
12	Max allowable torque (Continuous)	24 (15)	mNm
13	Max allowable torque (Intermittent)	60(30)	mNm

Spec Based on stages

	Gear Ratio	29	49	71	94	198	302	
14	Reduction ratio (absolute value)	29.07:1	48.58:1	71.35:1	93.68:1	198.06:1	301.84:1	
15	Number of stage	3	4	4	4	5	5	
16	Efficiency	73	66	66	66	59	59	%
17	Direction of rotation	≠	=	=	=	≠	≠	
18	Gearhead length : L1	9.6	11.6	11.6	11.6	13.6	13.6	mm
19	Weight	8.9	10.3	10	9.2	10.2	10.2	g

Combination with motor

Type	Model name	29	49	71	94	198	302	
Coreless Motor	CMS16-23..S	31.7	33.7	33.7	33.7	31	35.7	mm
	CMS16-28..S	36.7	38.7	38.7	38.7	35.2	40.7	mm
	CMS16-33..S	41.7	43.7	43.7	43.7	45.5	45.7	
Brushless Motor	BMS16-20..S	30.6	32.6	32.6	32.6	31.0	34.6	mm
	BMS16-30..S	40.6	40.6	42.6	37.0	44.6	44.6	mm